

County Surveyor's Record, Tillamook County, Oregon

CHAINS

Restored corner for State of Oregon--Department of Forestry
North one-sixteenth corner common to Sections 10 and 11, T1N, R7W,
W.M., Tillamook County, Oregon

ORIGINAL by A.G. Gibson RS 359, March 23, 1956. (Recorded in Book 2,
Page 341, Tillamook County Surveyors Office.)

1½" X 36" galvanized iron pipe with 3" bronze cap in mound of stone;
missing, torn out by Bonneville Power Administration bridge construction,
from which a:

32" Maple bears S68°W 54.6 ft.; now missing, torn out by BPA
bridge construction.

24" Maple bears S19½°E 34.1 ft.; now 27" in place, face grown
over.

4" X 6" X 72" white painted Cedar post 1.0 ft. SE; now missing,
torn out by BPA bridge construction.

East bank of creek 10.0 ft. West; destroyed by BPA bridge construction.

RESTORED

Var. 21°E

Set 1½" X 36" galvanized iron pipe with 3" bronze cap marked "OREGON
STATE BOARD OF FORESTRY N1/16 S10 S11 1982 RS 1998", 32 inches in
ground, in mound of rock, and from which a:

16" Forked Alder bears N34°E 43.9 ft. to bark scribes N1/16 S11 BT.

16" Forked Alder bears S18°W 56.0 ft. to bark scribes N1/16 S10 BT.

Center of Ben Smith Creek bears West 21.0 ft.; course N01°W from S06°E.

Center of Ben Smith Creek bears South 47.5 ft.; course N36°W from S36°E.

Set 4' X 4" x 60" whited painted Cedar post S52°E 4.7 ft. from corner pipe.
Oregon State Forestry Department metal location posters on 16" Forked
Alder BT bears S18°W and 27" Maple BT.

DATED: October 8, 1982

RESTORED BY: Anthony J. Klosterman RS 1998

PRESENT AND WITNESSED BY: David B. Buchholz

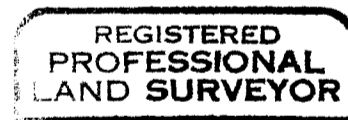

Anthony J. Klosterman

